

NOTE:
 BOTTOM LAYER OF INSULATION SHALL BE LAID DOWN IN
 A STAGGERED PROFILE. STAGGER AND OFFSET TOP LAYER
 OF INSULATION FROM BOTTOM LAYER TO PREVENT
 ALIGNED EDGES.

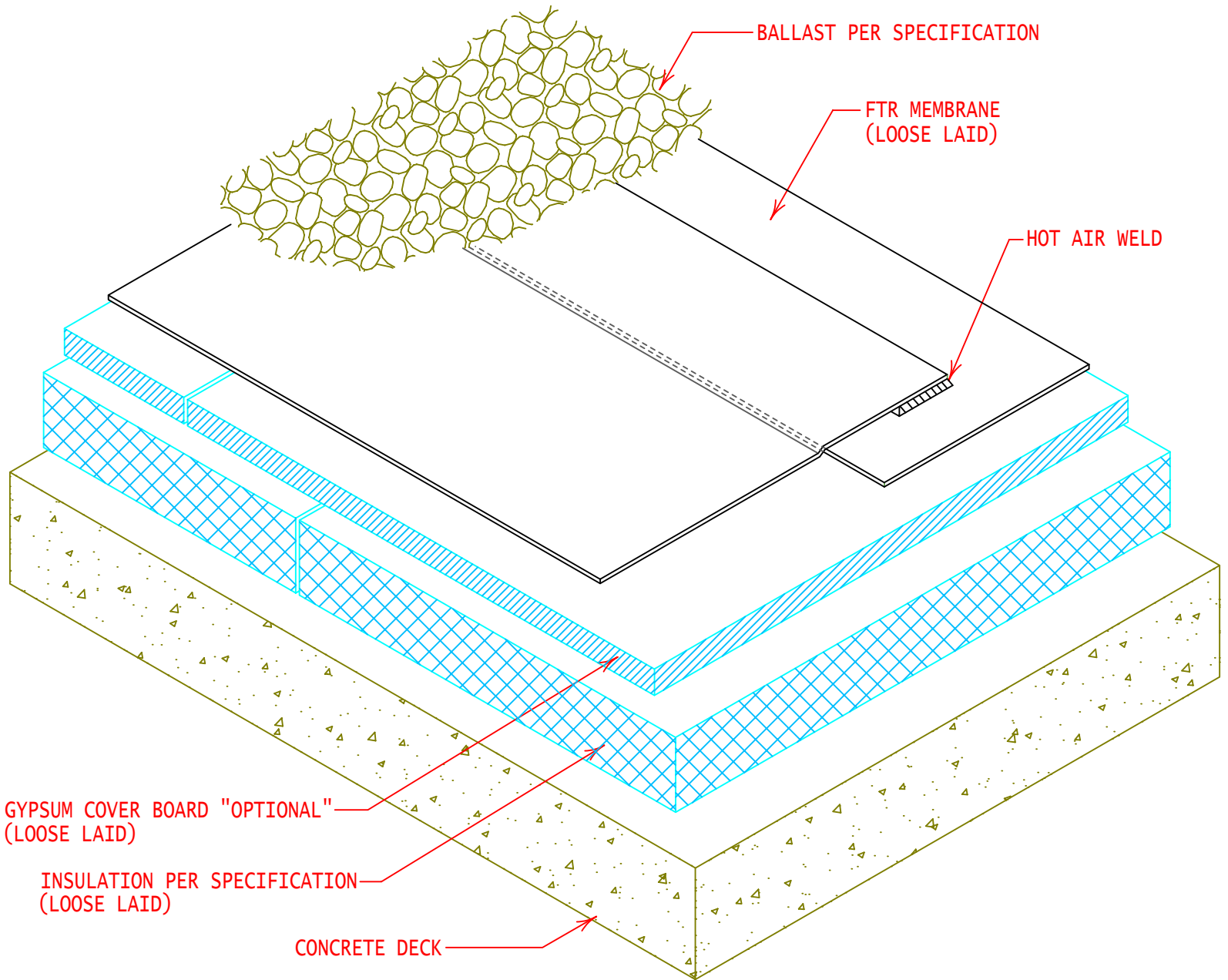

GYPSUM COVER BOARD "OPTIONAL"
 (LOOSE LAID)

INSULATION PER SPECIFICATION
 (LOOSE LAID)

CONCRETE DECK

BALLAST PER SPECIFICATION

FTR MEMBRANE
 (LOOSE LAID)

HOT AIR WELD



INTELLIGENT
 ROOFING SOLUTIONS

GENERAL REFERENCE:
 "FTR GS06"
 APPLICABLE SYSTEMS:
 "FTR BA06"

**COMPOSITE ROOF SYSTEM CROSS SECTION
 (BALLASTED SYSTEM)**

REVISES DETAIL	ISSUE DATE	DRAWING NUMBER
ALL PREVIOUS	03-01-07	FTR-DBS1