

| FIBERTITE 200 FASCIA SYSTEM |                    |                    |                 |
|-----------------------------|--------------------|--------------------|-----------------|
| Product ID. NO.             | H Dimension        | X Dimension        | Nailer Coverage |
| FAF-50                      | 5" (127.0 mm)      | 3" (76.2 mm)       | 1 NAILER        |
| FAF-65                      | 6-1/2" (165.1 mm)  | 4-1/2" (114.3 mm)  | 2 NAILERS       |
| FAF-80                      | 8" (203.2 mm)      | 6" (152.4 mm)      | 3 NAILERS       |
| FAF-95                      | 9-1/2" (241.3 mm)  | 7-1/2" (190.5 mm)  | 4 NAILERS       |
| FAF-110                     | 11" (279.4 mm)     | 9" (228.6 mm)      | 5 NAILERS       |
| FAF-125                     | 12-1/2" (314.5 mm) | 10-1/2" (266.7 mm) | 6 NAILERS       |

FM Approved up to 1-195

NOTE:  
 INSTALL PRE-MANUFACTURED EDGE SYSTEM PER SPECIFICATIONS AND FIBERTITE'S INSTALLATION REQUIREMENTS

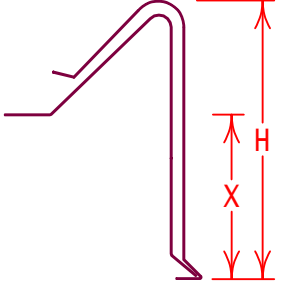
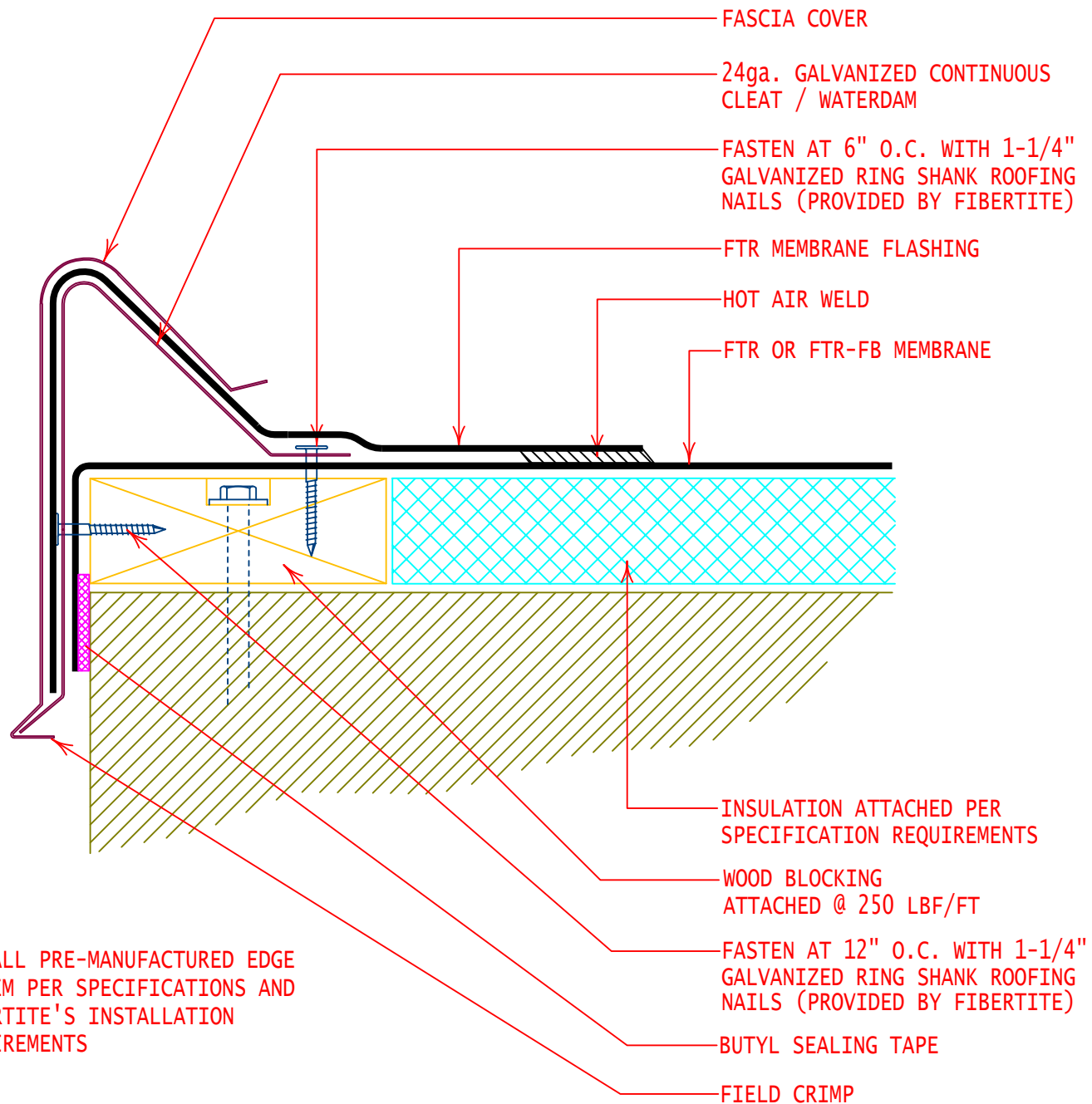

|   |            |                |
|---|------------|----------------|
| GENERAL REFERENCE:<br>"FTR GS06"                              |            |                |
| APPLICABLE SYSTEMS:<br>"FTR MA06"<br>"FTR AD06"<br>"FTR BA06" |            |                |
| <b>FIBERTITE 200 FASCIA SYSTEM<br/>(RAISED CLEAT EDGE)</b>    |            |                |
| REVISES DETAIL  | ISSUE DATE | DRAWING NUMBER |
| ALL PREVIOUS  | 03-01-07   | FTR-DE8a       |